

**Measuring max leech:**  
Fix the measurer edge to the jib halyard and hoist it to the top. Place the measurer towards the jib track until the measurer slightly touches spreaders and/or the lower diagonal shroud. Then place the traveler on that point and measure from halyard exit to the upper part of the clew traveler.

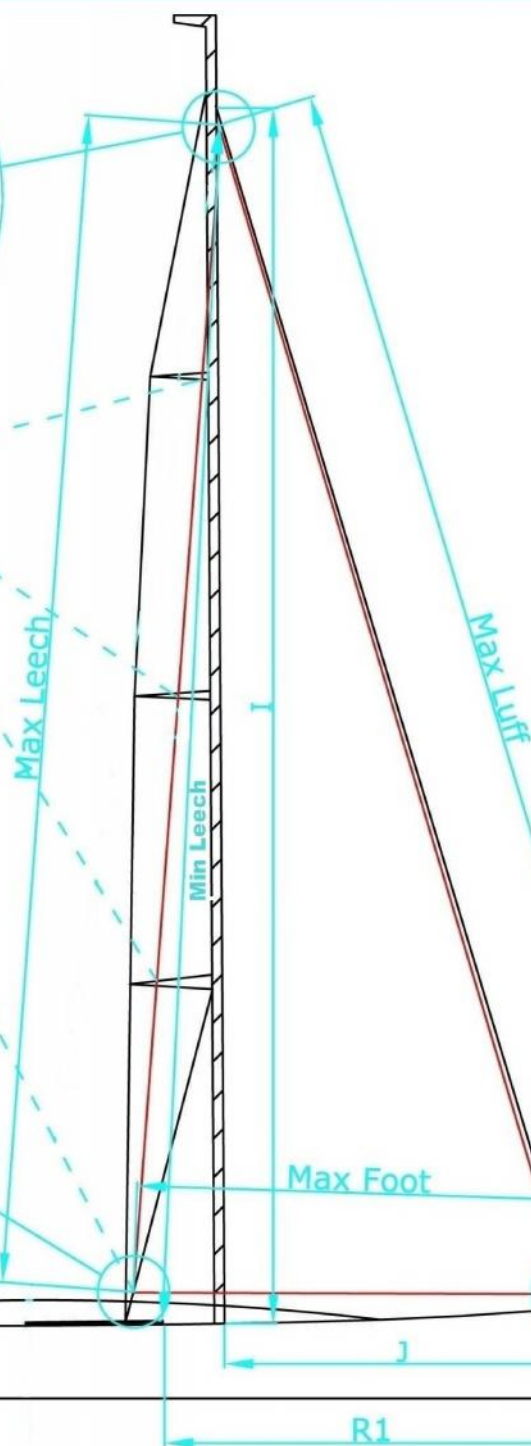

<b>Max Luff</b> From mast halyard exit to tack point	
<b>Max Foot</b> From tack point to clew traveler	
<b>Max Leech</b> From halyard exit to clew traveler	
<b>Max Leech with Tweaker</b> From halyard exit to tweaker	
<b>H Tweaker</b> From deck to tweaker	
<b>Cut Back</b> From tack point to luff groove	
<b>H Groove</b> From tack point to luff groove	
<b>Min Leech</b> From mast halyard exit to front track end	
<b>R1</b> From forestay fixing point to front track end	

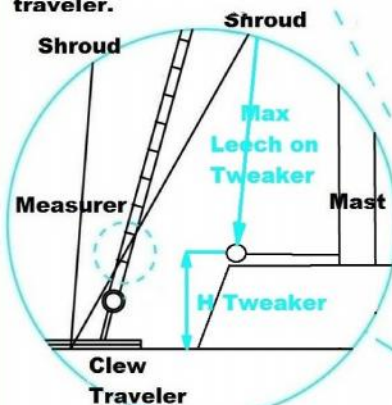
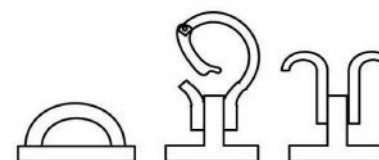

**Report tack point type**

- ☐ Transversal
- ☐ Longitudinal

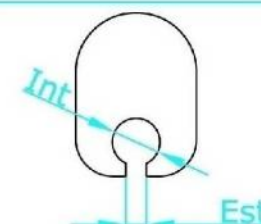
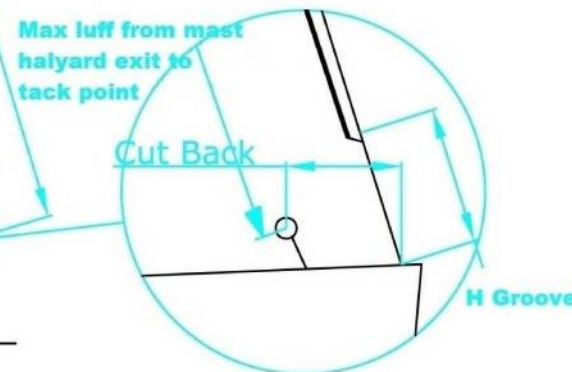

<b>Int</b>	
<b>Est</b>	
<b>I</b>	
<b>J</b>	

**When measuring the max leech, the measurer touches:**

- ☐ the lower shroud but not the lower spreader
- ☐ the lower shroud and the lower spreader

#### How to use the measurer

Dimensions has to be reported from the 0. If the 0 is not coinciding with the edge, fold the measurer on itself until the 0 lays on the edge and fix it with some tape.

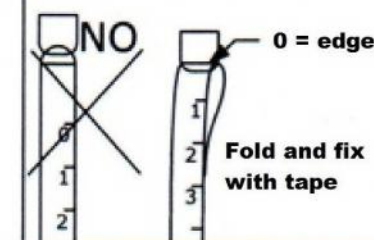

**Banks Sails**

**Jib Form**